

The Estate Agent People Recommend



47 Knights Way,  
Emmer Green  
RG4 8RJ

£340,000



Wentworth Estate Agents have pleasure in offering to the market an END OF TERRACE THREE BEDROOM PROPERTY in a very popular crescent.

The property benefits with a large garden and off road parking for a couple of cars. IN NEED OF FULL MODERNISATION THROUGHOUT THE PROPERTY and OPPORTUNITY TO EXTEND subject to planning permission.

Accommodation comprises of entrance hall, cloakroom, living room, dining room, kitchen, three bedrooms and family bathroom.

NO ONWARD CHAIN

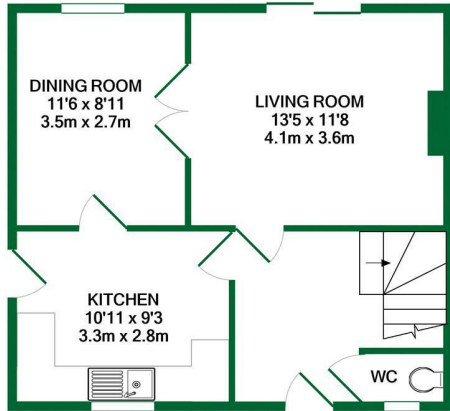

GROUND FLOOR

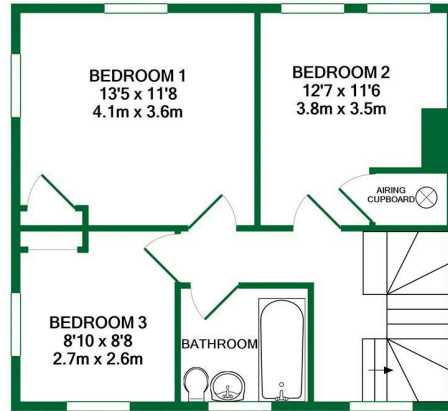

1ST FLOOR

TOTAL APPROX. FLOOR AREA 753 SQ.FT. (70.0 SQ.M.)

Whilst every attempt has been made to ensure the accuracy of the floor plan contained here, measurements of doors, windows, rooms and any other items are approximate and no responsibility is taken for any error, omission, or mis-statement. This plan is for illustrative purposes only and should be used as such by any prospective purchaser. The services, systems and appliances shown have not been tested and no guarantee as to their operability or efficiency can be given.

Made with Metropix ©2020



## ACCOMMODATION

- THREE BEDROOM END OF TERRACE
- PARKING FOR NUMEROUS CARS
- LARGE GARDEN
- REQUIRES FULL MODERNISATION
- NO ONWARD CHAIN



The Old Butchers, 15 High Street, Twyford, Berkshire, RG10 9AB  
 t: 0118 934 0027 e: twyford@wentworthea.com



wentworth\_ea



wentworthestateagents

IMPORTANT: we would like to inform prospective purchasers that these sales particulars have been prepared as a general guide only. A detailed survey has not been carried out, nor the services, appliances and fittings tested. Room sizes should not be relied upon for furnishing purposes and are approximate. If floor plans are included, they are for guidance only and illustration purposes only and may not be to scale. If there are any important matters likely to affect your decision to buy, please contact us before viewing the property.